

# ASSEMBLY INSTRUCTIONS

## RANGER STEEL FOUR-POST TABLES

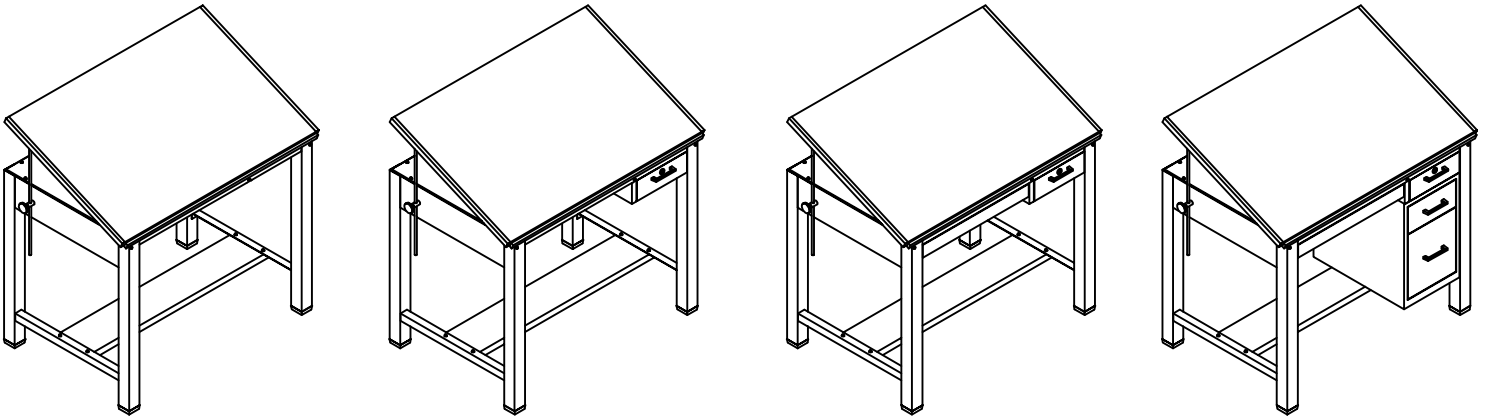

**NOTE:** Please count and inspect all pieces before disposing of any carton or packing materials.

When ordering components, specific color and/or size information may be required. Contact a Mayline Customer Service Representative. 1-800-822-8037

**COMPONENTS:** TABLE

REF. #	QTY.	DESCRIPTION	PART No.
1	1	R.H. END ASSEMBLY	CALL~~**
2	1	L.H. END ASSEMBLY	CALL~~**
3	1	FRONT RAIL	CALL~~**
4	1	REAR RAIL	CALL~~**
5	1	FOOT RAIL	CALL~~**
6	1	DUST COVER	CALL~~
7	2	TILT ROD ASSEMBLY	A315

**OPTIONAL COMPONENTS:**

The following components are in addition to the TABLE components.

**TOOL DRAWER ACCESSORY:**

8	1	CENTER SUPPORT	B7469**
9	2	DRAWER SLIDE	B6361**
10	1	TOOL TRAY	F187
11	1	TOOL DRAWER	A7553**

**SHALLOW DRAWER ACCESSORY:**

12	2	DRAWER SLIDE	B6361**
13	1	SHALLOW DRAWER	CALL~~**

**AUXILIARY DRAWER UNIT ACCESSORY:**

All components are included with the Drawer Unit.

\*\* Denotes Color Code  
 ~~Denotes Size

\*for individual item, order that part number

**HARDWARE BAG:** TABLE w/o DRAWER - PART No. A7680  
 TABLE with DRAWER - PART No. A7681

REF. #	QTY.	DESCRIPTION	PART No.
E1	2	LOWER HINGE	B195*
E2	2	UPPER HINGE	B194*
E3	4	#10-24 x 3/8 SCREW	X147*
E4	4	#10-24 KEPS NUT	T2*
E5	12	1/4-28 x 3/8 SCREW	X156*
E6	12	1/4-28 KEPS NUT	T25*
E7	11	#8 x 5/8 SCREW	X140A*
E8	10	#10 x 3/4 SCREW	X11*
E9	2	KNOB	K13*
E10	2	WASHER	W30*
E11	2	5/16-18 x 1/2 BOLT	X157*
E12	2	TILT ROD GUIDE	B160*

**OPTIONAL COMPONENTS HARDWARE:**

The following hardware is in addition to the Table Hardware .

**TOOL and SHALLOW DRAWER ACCESSORIES:**

E13	6	#10-24 x 3/8 SCREW	X147*
E14	4	#10-24 KEPS NUT	T2*
E15	1	DRAWER HANDLE	Q35*
E16	8	#8-32 x 3/8 THRD. CUTTING SCREW	X247*
E17	12	#8-32 x 5/16 MACHINE SCREW	X384*
E18	12	#8-32 ACORN NUT	T129*

**AUXILIARY DRAWER UNIT ACCESSORY:**

All hardware is included with the Drawer Unit.

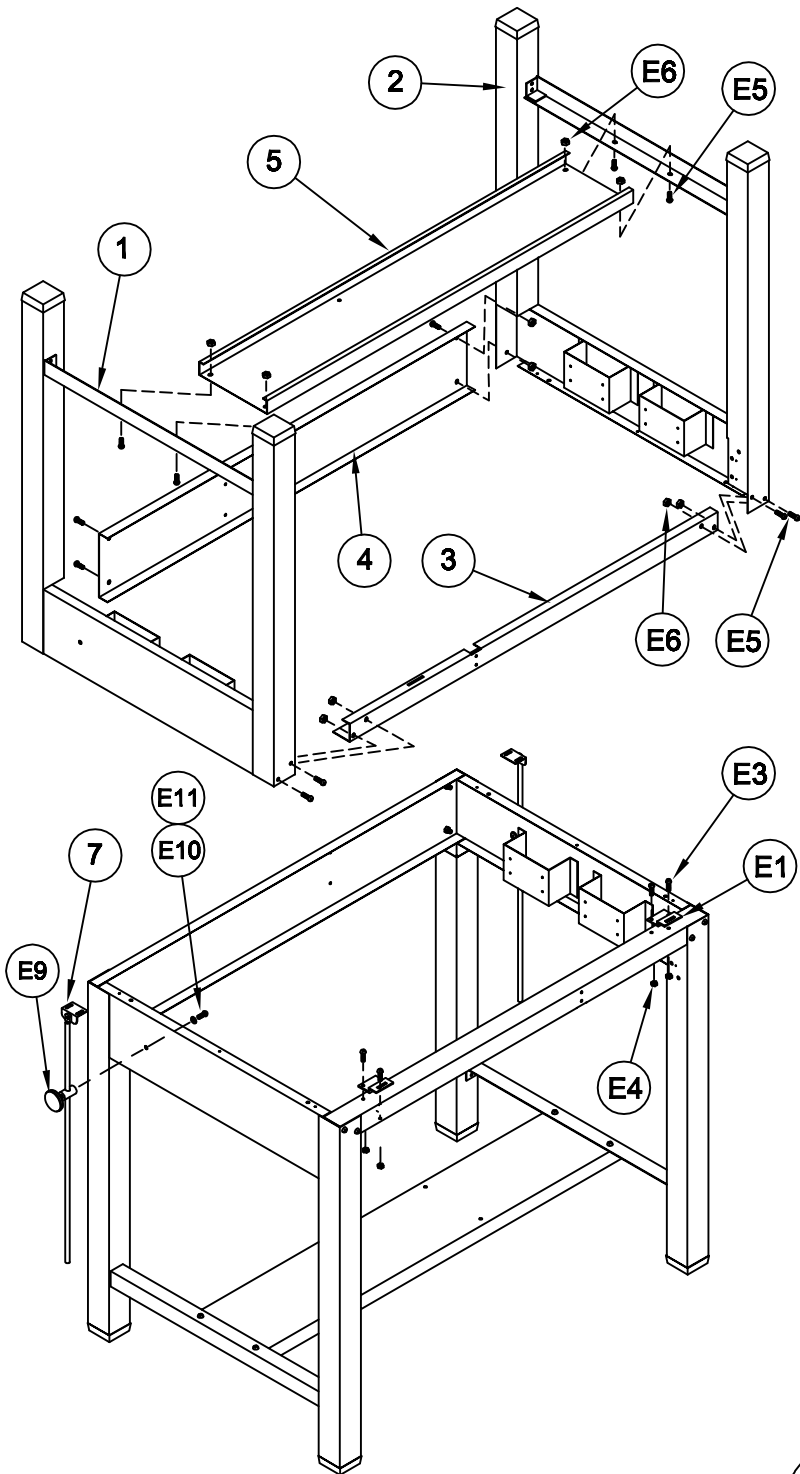

1. Place the two End Assemblies (1 & 2) upside. Position the Front Rail (3) with the larger of the two flanges toward the floor. Position the Rear Rail (4) with the Dust Cover attachment holes toward the floor. Secure these Rails to the End Assemblies with two Screws (E5) and two Nuts (E6) per end. **DO NOT** tighten screws at this time.

2. Position the Foot Rail (5) with flat surface toward the floor. Attach the Foot Rail to the End Assemblies with four Screws (E5) and Nuts (E6). **TIGHTEN** all rail attaching screws now.

3. Turn assembled table to an upright position. MAYLINE recommends that two people perform this task.

4. Fasten one Tilt Rod Guide (E12) to each side of the table using one Bolt (E11) and one Washer (E10) per guide. **DO NOT** tighten completely.

5. Insert Tilt Rod Assembly (7) through hole in Guide and tighten in place with Plastic Knob (E9).

**NOTE:** If your product is not equipped with the **OPTIONAL** Drawers or the **OPTIONAL** Auxiliary Drawer Unit, proceed to the final page of this Instruction Sheet for Top Installation.

## ASSEMBLY INSTRUCTIONS: OPTIONAL DRAWERS

1. Separate the Drawer Slides (9) into two pieces. Extend the Slide to the full extension. Remove the smaller portion (9B) by pressing the plastic release and pulling.

2. Attach the large Slide portion (9A) to the Center Support (8) using two Screws (E16). Begin attaching the Slide using the large 'Horizontal' slot in the last mounting tab.

**NOTE:** If you are installing the Optional Shallow Drawer, repeat steps #2 on the opposite side of the Center Support.

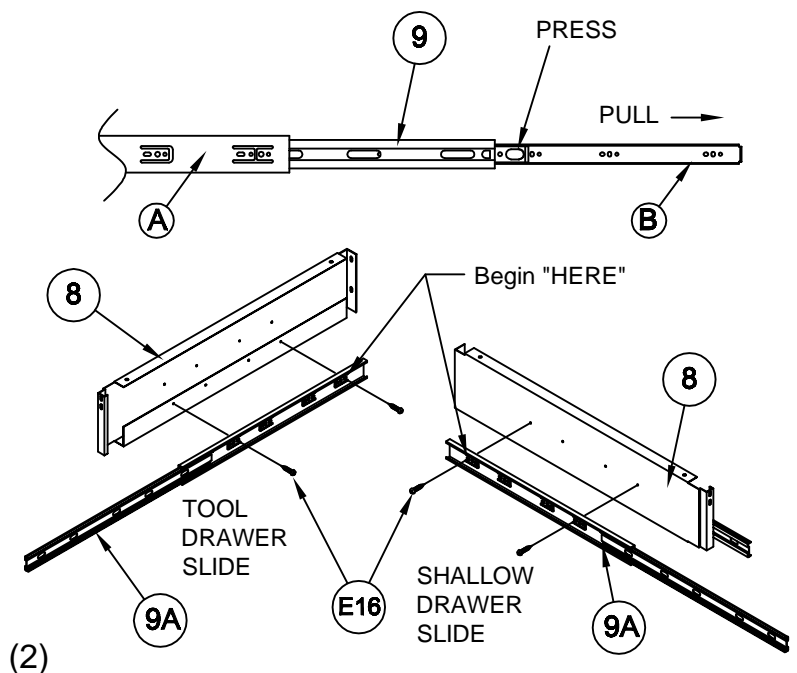

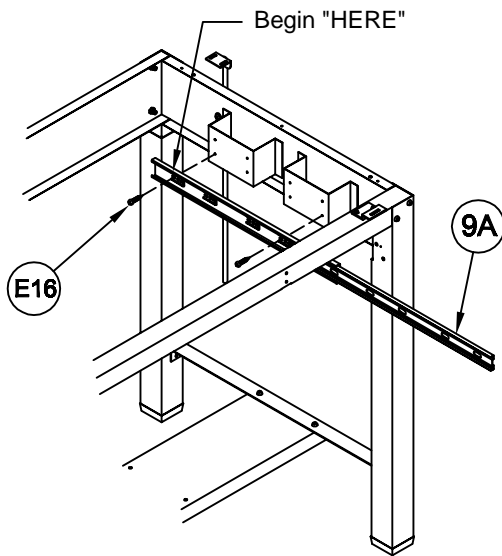

3. Attach one large Slide portion (9A) to the brackets on the R.H. side of the table using two Screws (E16). Begin attaching the Slide using the large 'Horizontal' slot in the last mounting tab.

NOTE: If you are installing the Optional Shallow Drawer, repeat this procedure on the opposite side of the Table.

4. Attach the smaller Slide portion (9B) to each side of the Drawer body using three Screws (E17) and three Acorn Nuts (E18). Begin attaching the Slide using the 'Vertical' slot in the first hole cluster.

NOTE: If you are installing the Optional Shallow Drawer, repeat this procedure for that drawer.

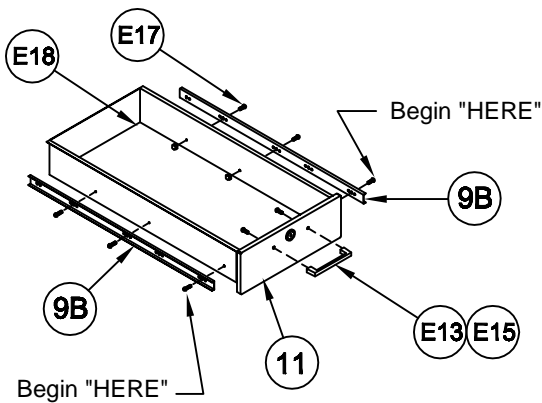

5. Install the Drawer Pull (E15) onto the Tool Drawer head using Screws (E13).

6. Install the assembled Center Support into the Base. Attach the Support with two Screws (E13) and two Nuts (E14) per rail.

7. Install the drawers into the assembled table.

8. Lay the Dust Cover (6) onto the table. Align the holes in the Dust Cover with the holes in the Rails and attach with Screw (E7).

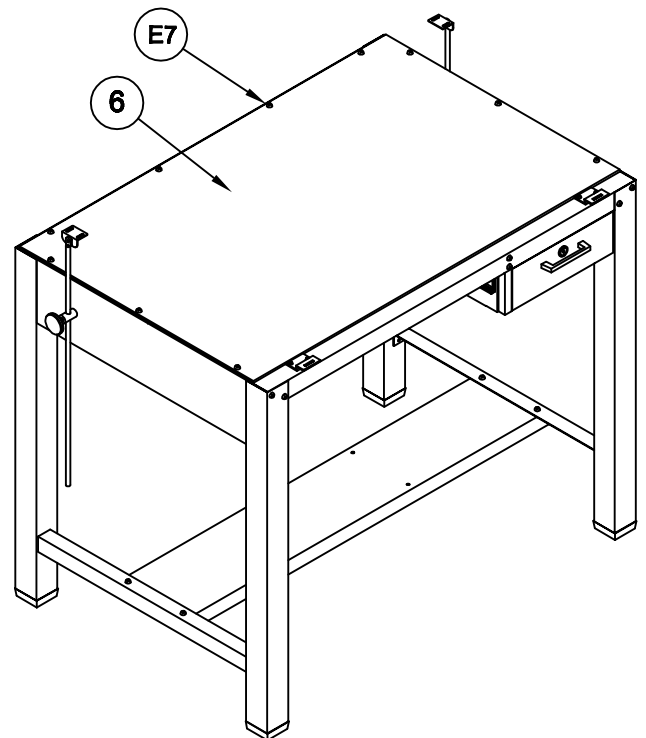
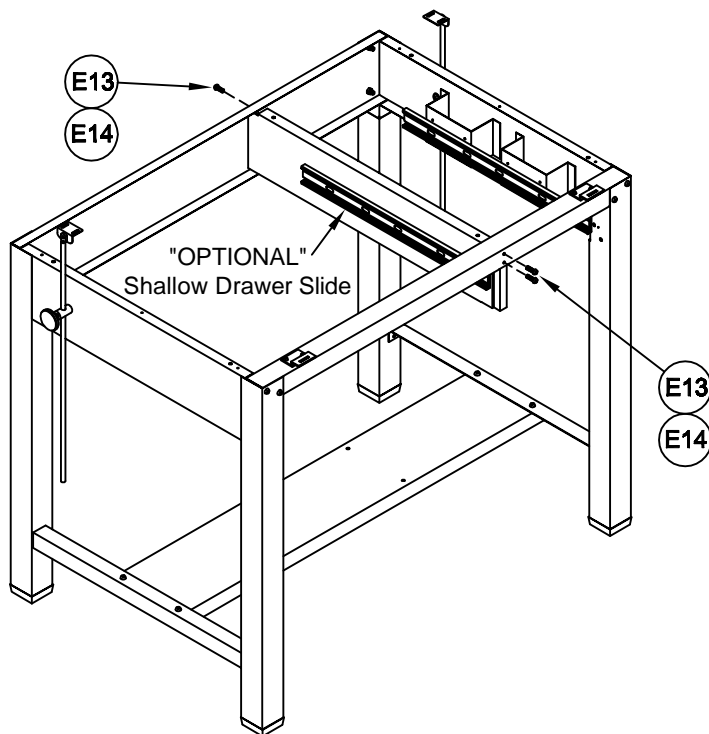

## AUXILIARY UNIT INSTALLATION:

**NOTE:** All attaching hardware is included with this unit.

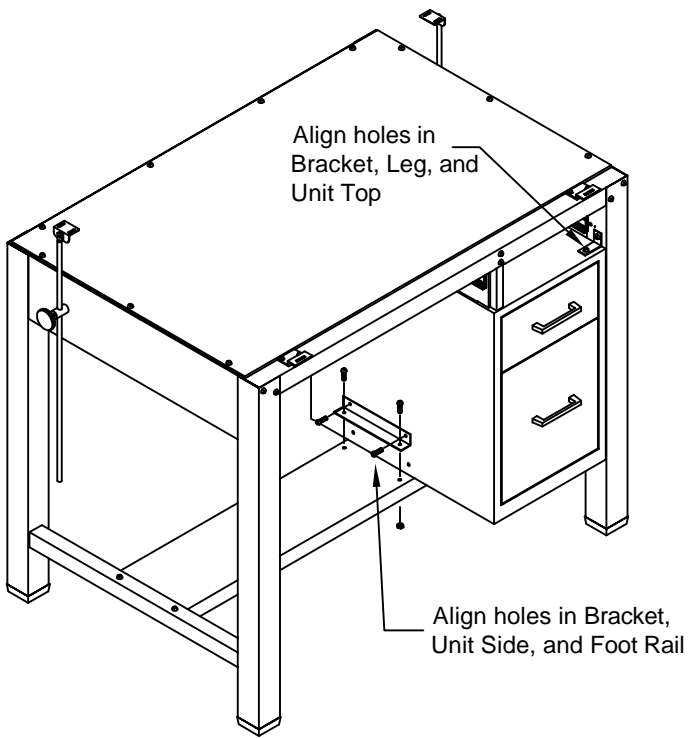

1. Remove the Tool Drawer from Base. Refer to Step 1 of the Optional Drawer assembly instructions.
2. Remove the drawers from the Auxiliary Unit.
3. Place the Unit Body onto the Table Foot Rail.
4. Align the Bracket holes with the holes in the Unit Side and the Foot Rail holes. Secure in place using screws and nuts.
5. Align the Bracket holes with the holes in the Unit Top and the Leg holes. Secure in place using screws and nuts.
6. Install all drawers.

---

## TOP INSTALLATION:

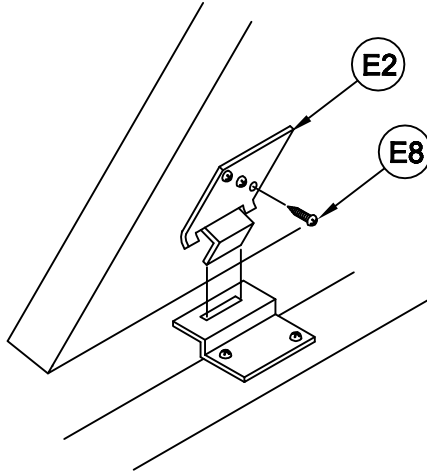

1. Align the holes in the Upper Hinge (E2) with the holes in the underside of the Top. Attach the Hinge using two Screws (E8) per Hinge.
2. Hold the Top in a vertical position and insert the ears of the Upper Hinge (E2) into the slots of the Lower Hinge (E1). Lower the Top.
3. Attach the Tilt Rods (7) to the Top using two Screws (E8) per Tilt Rod.

